

## Trojan Athena Hinge Adjustment Guide



### Lateral Adjustment

+/- 4mm

4mm Allen Key

Lateral Adjustment: (Note Lateral and height adjustment can be made simultaneously)  
Slacken off both M5 Cap Head Screws **on all hinges** (and ensure they are re tightened after adjustment)  
The Door can now be moved one way or the other about the nominal position

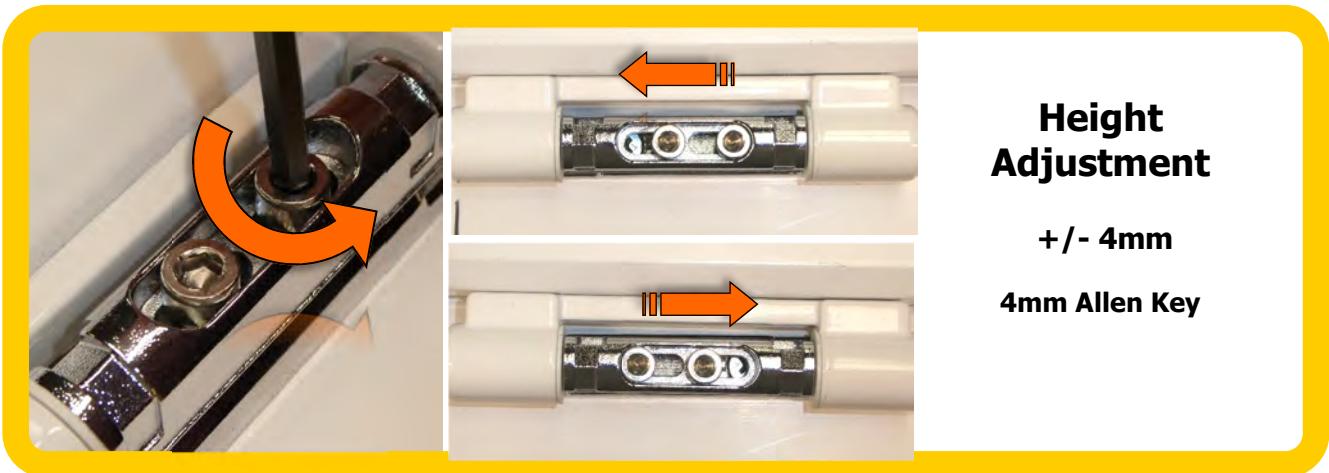

### Height Adjustment

+/- 4mm

4mm Allen Key

Lateral Adjustment: (Note Lateral and height adjustment can be made simultaneously)  
Slacken off both M5 Cap Head Screws **on all hinges** (and ensure they are re tightened after adjustment)  
The Door can now be moved up or down about the nominal position

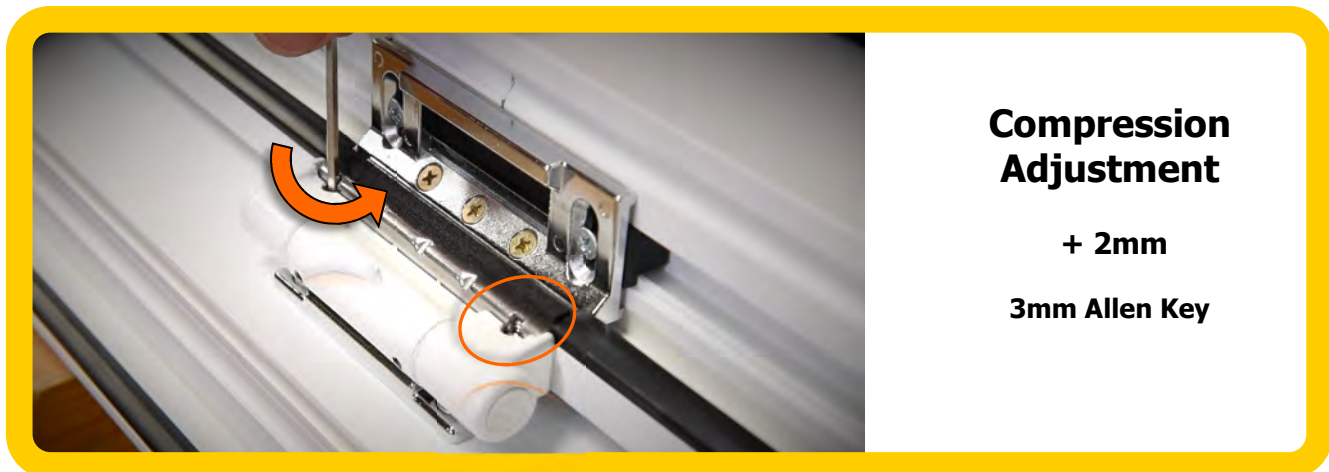

### Compression Adjustment

+ 2mm

3mm Allen Key

Open the Door to expose the Compression Adjustment Grub Screws  
Rotate the Grub Screws Anti-Clockwise to increase compression using a 3mm Allen Key  
Note both Grub Screws must be rotated by an equal amount to ensure even adjustment